



Chamberlain Close, Ilford, IG1 1JQ

Offers In Excess Of £225,000



Chamberlain Close

Ilford, IG1 1JQ

- EPC - D
- PARKING SPACE
- CLOSE TO STATION
- CLOSE TO ILFORD HIGH ROAD
- SECOND FLOOR APARTMENT
- BALCONY
- CLOSE TO ILFORD LANE
- GATED DEVELOPMENT

SECOND FLOOR APARTMENT - PARKING SPACE - GOOD SIZE BACONY - CHAIN FREE

Sandra Davidson Estate Agents are pleased to present this spacious second floor one double bedroom apartment in this gated development off Richmond Road IG1. This spacious apartment is located within walking distance to Ilford Station (Crossrail - Zone 4 - TFL Rail) giving easy access to Stratford and Liverpool Street. The apartment is surrounded by a variety of amenities such as local shops, restaurants, places of worship and fantastic transport links. The apartment comprises: spacious lounge open to kitchen, double bedroom with fitted wardrobe and a bathroom with a window.

Viewings are highly recommended.



GATED DEVELOPMENT
COMMUNAL ENTRANCE
FLAT ENTRANCE

RECEPTION ROOM	16'0" x 12'3" (4.90m x 3.74m)
KITCHEN	7'10" x 6'0" (2.41m x 1.85m)
BEDROOM ONE	12'2" x 9'0" (3.72m x 2.76m)
BATHROOM	7'3" x 6'0" (2.21m x 1.83m)
BALCONY	18'2" x 6'4" (5.56m x 1.95m)

PARKING

AGENTS NOTE



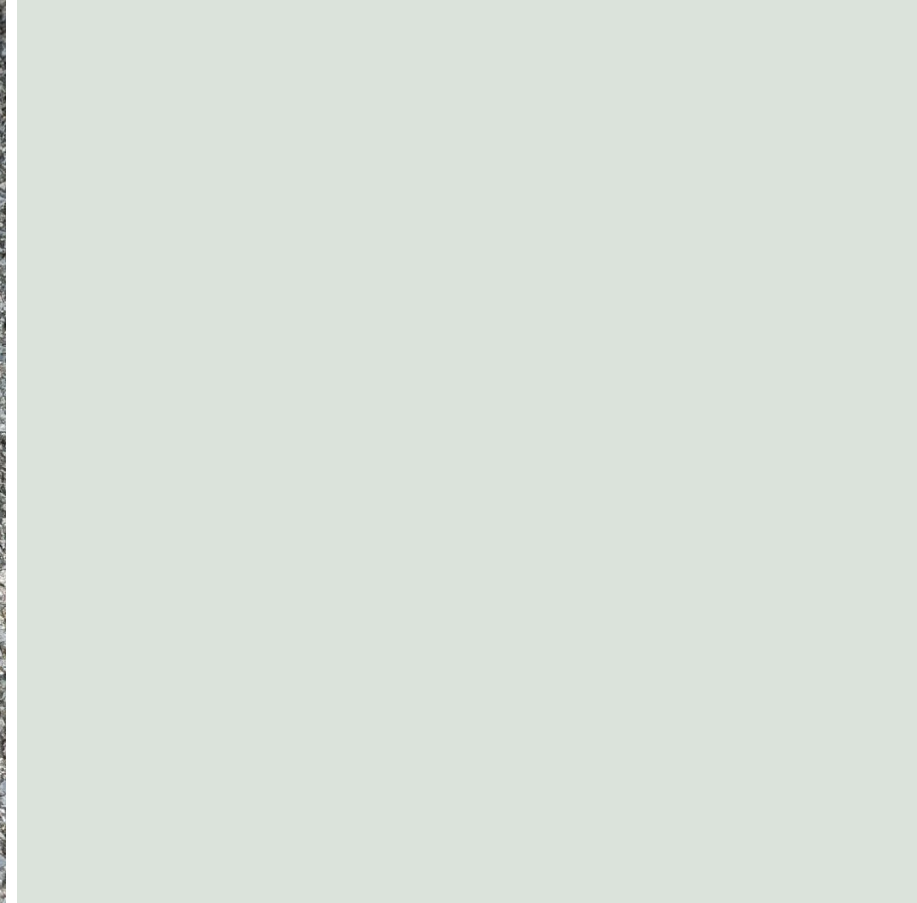

Directions

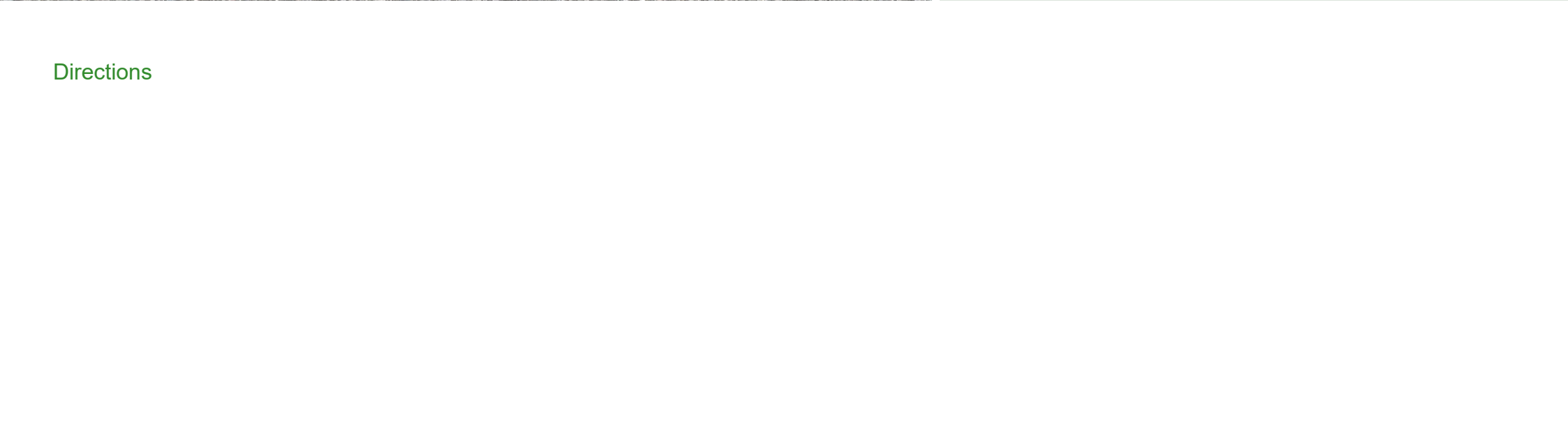

Floor Plans

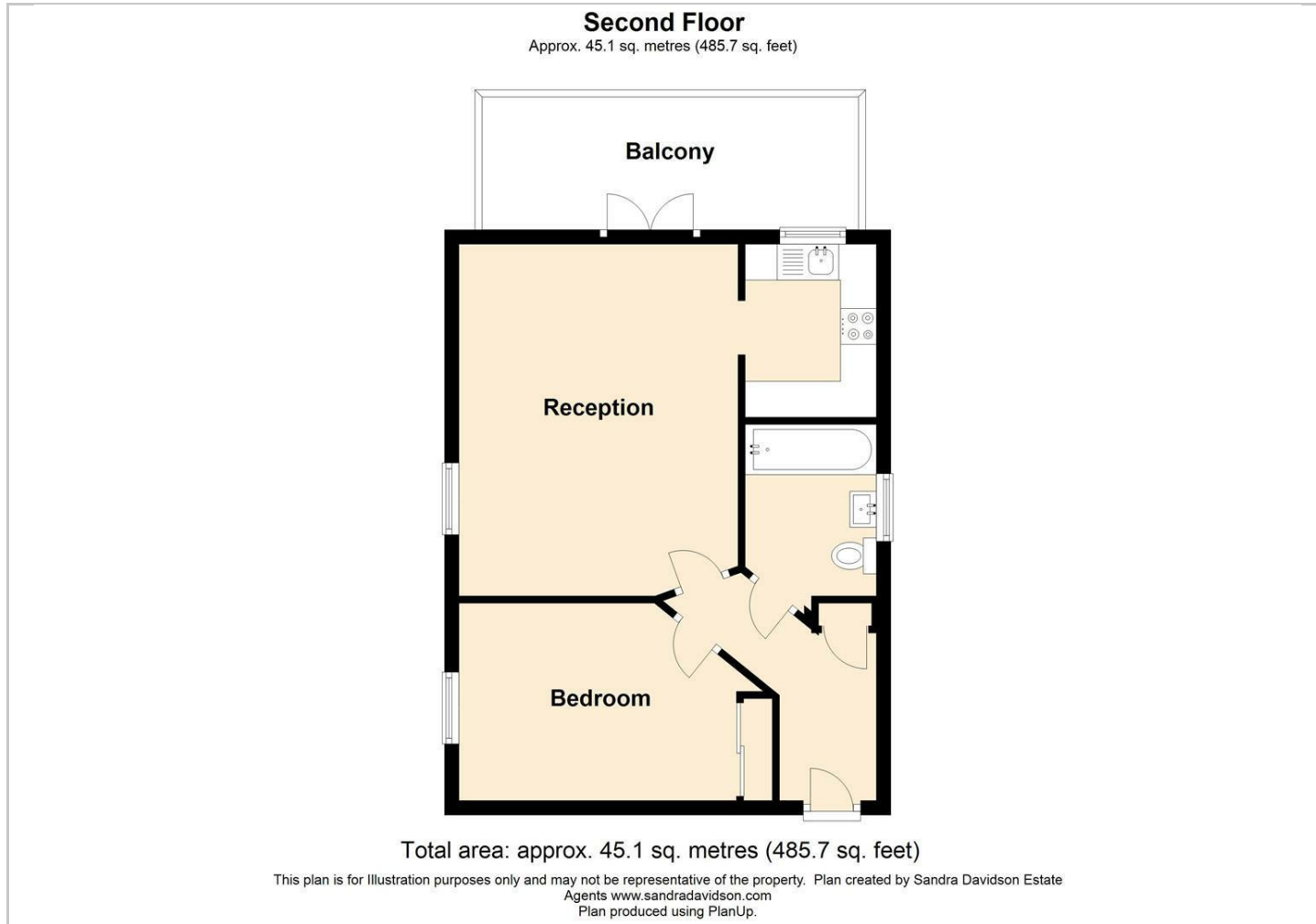

Viewing

Please contact our Seven Kings Sales Office on 020 8597 7372 if you wish to arrange a viewing appointment for this property or require further information.

The particulars are set out as a general outline only for the guidance of intended purchasers or lessees, and do not constitute, any part of a contract. Nothing in these particulars shall be deemed to be a statement that the property is in good structural condition or otherwise nor that any of the services, appliances, equipment or facilities are in good working order. Purchasers should satisfy themselves of this prior to purchasing.

353 Green Lane, Seven Kings, Essex, IG3 9TH
Tel: 020 8597 7372 Email: sevenkings@sandradavidson.com <https://www.sandradavidson.com>

Location Map

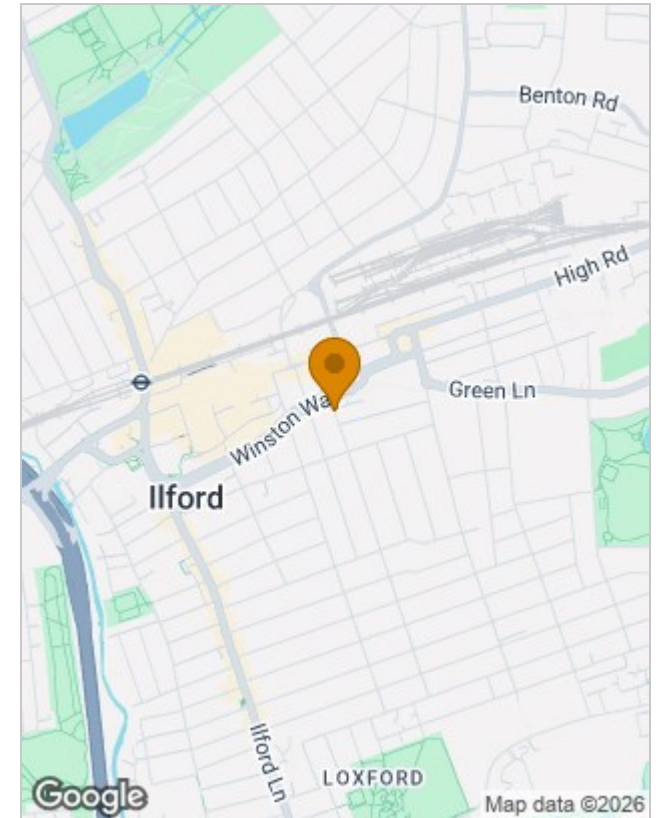

Energy Performance Graph

